



Right where you belong



**Admissions 2026**

[nipissingu.ca/futurestudents](http://nipissingu.ca/futurestudents)





# Top 10 Reasons to Choose Nipissing



# 1

## Our Grads Get Jobs

Over 96.8% of Nipissing University students find employment within six months of graduating.



# 2

## Residences That Feel Like Home

Enjoy a private room of your own in a four-bedroom apartment-style suite! Make new friends, take part in residence life activities and events, and have privacy when you need it.

➤ See page 10

# 3

## Top-Ranked Student Services

Benefit from the support of the #1 student services in Ontario.\*

➤ See page 24

# 4

## Scholarships

Take advantage of over \$4.5 million in scholarships, bursaries and awards available to students.

➤ See page 14

# 5

## Picture-Perfect Campus

Naturally beautiful, featuring state-of-the-art facilities.

# 6

## Undergrad Research

Gain experience conducting graduate-level research as an undergraduate student.

\*Among primarily undergraduate universities in Ontario, Maclean's 2025

# 7 Hands-On Learning

Get real-world experience through co-ops, placements, and internships. ➤ See page 4

# 8 Small Class Sizes

Small class sizes mean it's easy to meet new people, get to know your professors and engage in lively discussions.

# 9 Athletics

Go Lakers! Nipissing University has a wide range of intramural, club and varsity level sports to keep you on your game. ➤ See page 22



# 10 Friendly Community

From the moment you connect with Nipissing University, you'll immediately feel part of our friendly and supportive community.

## Contents

Areas of Study (Programs) .....	2	Your Campus Community .....	20
Hands-on Learning.....	4	Nipissing University Student Union (NUSU) ..	20
The Schulich School of Education.....	6	Athletics.....	22
Degree/Diploma Programs in Indigenous Education .....	7	Student Services and Support .....	24
Other Pathways to a Degree .....	9	Campus Map .....	28
Residence .....	10	Apply for Admission (Important Dates) .....	30
Finance Your Education (Scholarships).....	14	Applying to Study Full-Time .....	32
Financial Planning.....	16	Out-of-Province Admission Requirements ....	33
Dining on Campus .....	17	Admissions Chart.....	34
About North Bay .....	18	Concurrent Education Programs.....	36

Nipissing University sits on the territory of Nipissing First Nation, the territory of the Anishnabek, within lands of the Robinson Huron Treaty of 1850. We are grateful to be able to live and learn on these lands with all our relations.

“Nipissing” (Nbisiing) is an Anishinaabemowin word meaning ‘people of the little water’ and anchors the university with the Nipissing peoples whose traditional territory includes Lake Nipissing and the surrounding area.

# Areas of Study

Discover a degree path that aligns with your passion. Our flexible programs let you structure and customize your studies to fit your goals. For admissions requirements and degree designations (e.g. BA vs BSc) please see the charts at the end of this book starting on page 34.

## Arts and Science

Anthropology

Biology

Child and Family Studies

Computer Science

Data Science

English Studies

Environment and Physical Geography\*

Environmental Biology and Technology\*

Environmental Geography\*

Environmental Science

Fine Arts

Gender Equality and Social Justice

Geography

History

Indigenous Studies

Liberal Arts

Liberal Science

Mathematics

Philosophy

Political Science

Psychology

Religions and Cultures

Social Welfare and Social Development

Sociology

Average Class Size **33**

## Education

For more information about the offerings from the Schulich School of Education, see page 6.

### Concurrent Education – Dual Degree

Nipissing offers a 6-year concurrent program that lets you earn two degrees – an honours undergraduate degree in your chosen area of study (except Commerce, Nursing, and Social Work), and a Bachelor of Education degree.

### Consecutive Education

A 2-year program for those students who have already completed a 3 or 4 year undergraduate degree.

### Degree/Diploma Programs in Indigenous Education

See page 7 or visit

[nipissingu.ca/indigenouseducation](http://nipissingu.ca/indigenouseducation) for more information.

## Professional Studies

### Business

Concentrations in: Accounting, Entrepreneurship and Innovation Leadership, Finance, Human Resources, International Business, and Marketing.

### Bachelor of Commerce – Distance

Concentrations in: Accounting and Human Resources.

### Bachelor of Commerce – Dual Degree

Combine Business with an Arts or Science program – complete a Bachelor of Arts or Bachelor of Science degree with a Bachelor of Commerce degree in as little as five years.

### Criminal Justice

Streams in: Corrections and Community Justice Services, Criminal Justice Studies, Criminology, and Policing

### Nursing

### Physical and Health Education

### Social Work

**Ask about the BBA co-op program!**

Complete paid work terms while earning your degree.

\*Not available as a minor





No specific degree or major is required for Law, Medical, MBA, or Veterinary schools. Nipissing University offers all prerequisite courses required for admission to these programs.

## Minors

In addition to your main degree, you may choose to study additional subjects. The following minors are offered at Nipissing, subject to availability. Minors are also available in the Faculty of Arts and Science areas of study (on the previous page) with a few exceptions marked by an asterisk.

### Business Minors:

Accounting  
Business Administration  
Corporate Social Responsibility  
Entrepreneurship  
Finance  
Human Resources  
International Business  
Marketing

### Chemistry

Environmental Science

### Film

### Fine Arts Minors:

Art History and Visual Studies  
Studio Arts

### French

### Human Rights

### Legal Studies

### Media, Culture, and Communications

### Media, Representation, and Social Justice

### Physics

### Spanish

### Study of State Violence (War, Atrocity, and Genocide)

## Certificates

Certificates are earned by completing a selection of courses within a degree program.

Please see the Admissions Chart on pages 34-37 for a list of certificates eligible with your program.

### Applied Behavioural Sciences (ABS)

### Archaeological Monitoring

### Bilingualism

### Conflict Resolution and Negotiation

### Early Intervention

### Environmental Management

### Forest Resource Management and Conservation

### Game Design and Development

### Geomatics

### Health Studies and Gerontology

### iLEAD Business Experience

### Neuroscience

### Program Evaluation and Applied Research (PEAR)

### Societies in Transition: Relationship, Reciprocity, and Reconciliation Histories

### Study of State Violence (War, Atrocity, and Genocide)

Motion capture equipment at the Centre for Physical and Health Education.

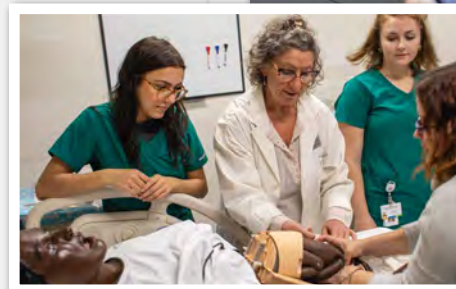
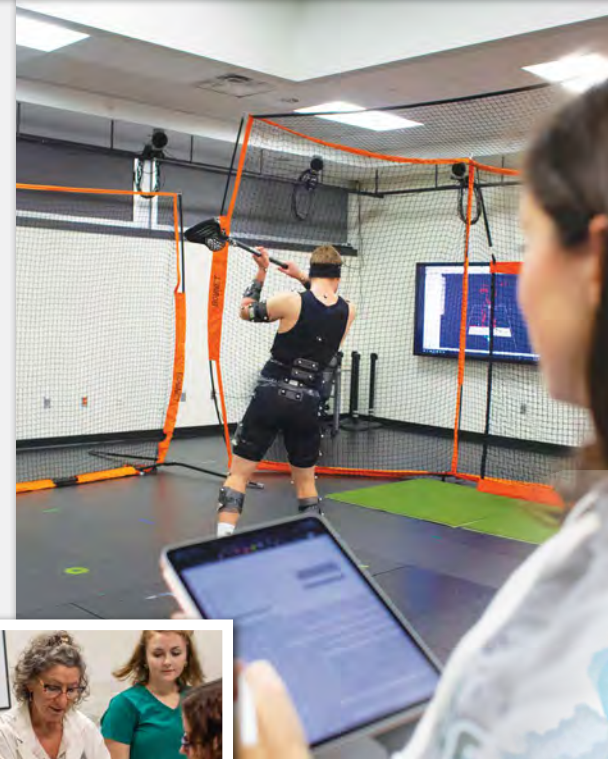

For more information, please visit [nipissingu.ca/programs](http://nipissingu.ca/programs)

# Hands-On Learning

Experiential learning is one of the best ways to apply skills and concepts learned in the classroom to a practical setting. At Nipissing, we offer a wide range of hands-on learning opportunities, resulting in uniquely employable graduates who are ready to lead.

## Co-ops, Placements, and Internships

In many programs, experiential learning opportunities are built right into the curriculum in the form of placements, volunteer opportunities, professional internships, co-ops, and practicums. Through these experiences, students develop competencies in communication, critical thinking, collaboration, problem solving and leadership that help pave the way for future success.

## BBA Co-op Program

Students in the School of Business BBA Co-op Program alternate academic terms on campus with full-time work terms. Students apply theoretical knowledge from course studies in the workplace and return to the classroom with practical workplace experience. Co-op helps students determine their strengths and interests, test-drive potential careers and gain valuable experience in their discipline.

Questions? Email [business@nipissingu.ca](mailto:business@nipissingu.ca) to learn more.

Unlock your potential:  
take advantage of undergraduate  
research opportunities.

“*Research opportunities at Nipissing have been central to my growth as a student and aspiring academic. Working closely with faculty on independent projects and conference presentations has not only deepened my understanding of psychology but also given me the skills and confidence to contribute meaningfully to the field.*”

- Prisha V., third-year Psychology student





## iLEAD Business Experience Certificate and Expeditions

Students pursuing the iLEAD Business Experience Certificate have the opportunity to Learn through Experience, Action and Discovery in the form of directed studies, workplace internships, overseas studies and volunteer service to others.

## Biidaaban Community Service-Learning (BCSL)

**Biidaaban is an Anishnaabe word meaning “the point at which the light touches the earth at the break of dawn.”**

BCSL is a unique experiential learning program that allows students to volunteer within community organizations for course credit through project-based learning or placements. Students can also support Indigenous children and youth through the Biidaaban Youth Group and Biidaaban Academic Support programs. Participants receive training from Elders, Indigenous knowledge holders, faculty, educators and community members throughout their placements.

## The George and Helen Vari Simulation Centre

The George and Helen Vari Simulation Centre offers an immersive, interactive learning environment designed to replicate a variety of real-life situations, procedures, and environments.

The state-of-the-art space features four hospital simulation suites with life-like manikins that can mimic a variety of healthcare and other professional situations. Students are able to build competency in their skills, practice critical thinking, and make mistakes in a safe, supportive, and controlled environment to help prepare them for professional practice.

Using immersive projection technology, two dedicated rooms can be transformed into various settings such as a hospital, clinic, large group gathering or disaster scene. Students navigate the environment using interactive touch points on the walls.

The Centre also features a home apartment setting that can simulate home visits, crime scene investigations, and more for students from multiple disciplines such as nursing, social work, and criminal justice.

[nipissingu.ca/simulationcentre](http://nipissingu.ca/simulationcentre)



Nipissing hosts an annual Undergraduate Research Conference and invites undergraduate researchers from across Ontario to participate. Learn more at [nipissingu.ca/ugrc](http://nipissingu.ca/ugrc)

# The Schulich School of Education

The Schulich School of Education at Nipissing University is a recognized leader in the field of teacher education. Earn your Bachelor of Education (BEd) degree in one of the pre-eminent education programs in Ontario. Renowned for graduating exceedingly well-prepared and professionally-minded teachers, the Schulich School will prepare you for teaching in traditional and non-traditional environments, and provide you with transferable communication and collaborative skills that are essential to any career.

With a history of over 100 years of teacher education, combined with a rigorous offering of professional learning opportunities, the Schulich School of Education immerses teacher candidates in a series of experiential learning opportunities that may range from the integration of digital technology in the classroom, to national and international experiences, to polishing résumés and interview techniques prior to the annual education career fair. Schulich School of Education graduates maintain a distinct reputation as leading-edge and professional educators.

Earn your teaching certification through the Concurrent or the Consecutive BEd degree programs, or see page 7 for Degree/Diploma Programs in Indigenous Education.

For more details on our offerings, including graduate studies and additional qualification courses for teachers, visit [nipissingu.ca/schulich](http://nipissingu.ca/schulich).





## Pursuing a Degree in Education

	Concurrent Bachelor of Education	Consecutive Bachelor of Education
Description	Students graduate with a Dual Degree – an honours undergraduate degree in their discipline of choice (except Nursing and Social Work) and a Bachelor of Education degree.	A program for those students who already have a completed 3 or 4 year undergraduate degree from Nipissing or another university.
Duration	6 years	2 years (following an undergraduate degree)
Practicum	19 weeks of practicum + 60 hours of Community Leadership Experience (CLE) English Public school boards, English Separate school boards, and First Nations or federally administered schools	
Division	Choose one of the following: P/J – (JK/SK to Grade 6) P/J – French as a Second Language	J/I – (Grades 4 to 10) I/S – (Grades 7 to 12)
How to Apply	Apply through <a href="http://ouac.on.ca">ouac.on.ca</a> by <b>Jan 15, 2026</b>	Apply through <a href="http://ouac.on.ca">ouac.on.ca</a> by <b>Dec 1, 2025</b>

P/J =Primary/Junior J/I = Junior/Intermediate I/S = Intermediate/Senior

## Degree/Diploma Programs in Indigenous Education

For more information about our summer diploma programs, including admission requirements, tuition, family support, deadlines and the application process, please visit [nipissingu.ca/indigenouseducation](http://nipissingu.ca/indigenouseducation) or email [indigenouseducation@nipissingu.ca](mailto:indigenouseducation@nipissingu.ca)

### Indigenous Teacher Education Program (ITEP) Degree/Diploma

The Indigenous Teacher Education Program (ITEP) Degree/Diploma program is available for individuals of Indigenous ancestry.

This summer intensive program prepares individuals to develop teaching strategies, technological skills and curriculum knowledge within an Indigenous worldview. The program's structure allows working professionals to attend classes in the summer and to return to employment during the academic year. Upon completion, successful applicants will earn a Certificate of Qualification from the Ontario College of Teachers in the Primary/Junior Divisions.

New students entering the Indigenous Teacher Education Program may be eligible for a **\$7,500** Schulich Scholarship.



## Degree/Diploma Programs in Indigenous Education (continued)

### Indigenous Classroom Assistant Diploma Program (ICADP)

The Indigenous Classroom Assistant Diploma Program (ICADP) offers its candidates the opportunity to explore the role of the classroom assistant who works with Indigenous children in elementary public and First Nation schools.

Students explore culturally relevant pedagogical understandings in working with elementary students of all academic levels in numerous subject areas.

Practicum experiences allow students to connect educational theory with practical applications in the classroom and the entire school. Our graduates return to their classrooms with newly acquired skills and knowledge gained from the Indigenous Classroom Assistant Diploma Program to assist Indigenous children in elementary classrooms across the province.

### Teacher of Indigenous Language as a Second Language (TILSL) Degree/Diploma

The TILSL Program provides students who are fluent in the languages of Anishnaabemwin, Cree, Lunaape, Mohawk and Cayuga the opportunity to earn a Diploma in Education or Bachelor of Education Degree from Nipissing University and a Certificate of Qualification and Registration from the Ontario College of Teachers: Indigenous Language (K-12). Indigenous Language teacher candidates will acquire a thorough understanding of culturally-based teaching strategies, as well as explore new technologies to deliver Indigenous traditional teachings and Indigenous languages as a subject within First Nation and Ontario public schools from Kindergarten to grade 12. The program's structure allows working professionals to attend classes in the summer and to return to employment during the academic year.

For more information, please visit [nipissingu.ca/indigenouseducation](http://nipissingu.ca/indigenouseducation) or email [indigenouseducation@nipissingu.ca](mailto:indigenouseducation@nipissingu.ca)





# Other Pathways to a Degree

## College/University Transfer

Looking to transfer from college or university? Nipissing offers a variety of pathways for students who have started their studies at another postsecondary institution. Whether you're coming from a college or university, we'll help you explore transfer options and apply eligible credits toward your Nipissing degree. Learn more and view our Transfer Guide at [nipissingu.ca/futurematuretransferstudents](http://nipissingu.ca/futurematuretransferstudents).

## Mature and Transfer Applicants

If you're a mature student or transferring from another institution, be sure to explore our Mature/Transfer Student Guidebook for details on how to navigate your academic journey and make the most of your prior learning, [nipissingu.ca/futurematuretransferstudents](http://nipissingu.ca/futurematuretransferstudents).

## Indigenous Foundations Program (IFP)

[indigenousprograms@nipissingu.ca](mailto:indigenousprograms@nipissingu.ca) · [nipissingu.ca/indigenous](http://nipissingu.ca/indigenous)

This full-time, first year transition-to-university program is designed for Indigenous students who are planning to pursue an undergraduate degree and want access to cultural, personal, and/or academic resources. Students who are transitioning from high school, upgrading, entering from a college program, or who have simply taken a break from their studies are eligible.

Students are part of a community of peers, staff, faculty, and Elders while obtaining 24 credits toward a university degree in pre-selected courses for IFP students, and will:

- Learn alongside other Indigenous students;
- Attend orientation week to meet the professors and other students in the program;
- Become more familiar with the university system;
- Gain confidence to be successful at university.

To apply to the Indigenous Foundations Program, prospective students can find the printable or fillable PDF application form at [nipissingu.ca/indigenous](http://nipissingu.ca/indigenous). For more information, please contact the Indigenous Student Success and Development Coordinator at [indigenousprograms@nipissingu.ca](mailto:indigenousprograms@nipissingu.ca)



During the summer, students enrolled in Nipissing's Indigenous education programs (IFP) are invited to live in residence with their families, with summer camps available for their children as part of the seasonal offerings.

# Residence

A private bedroom of your own

## Your NU Home

Our top-rated residences will make you feel right at home. You can count on making great friends within your residence community while also enjoying the luxury of a private room of your own in a four-bedroom suite. Living in residence means you'll be surrounded with personal and academic supports, new friends from around the world, and exciting experiences and memories that will last long after graduation.

## Be Part of the Action!

Get involved and make lifelong friendships by taking part in movie nights, Social Committee, paint nights, cooking tutorials, ping-pong tournaments and more! Our dedicated student leaders always have something exciting planned. Have an idea for your own event? Let our student leaders know and they'll make it happen!



“Living in Residence was wonderful because we often gathered in the common area to study together, went out for groceries, and cooked meals as a group. One of my favourite memories was when everyone would come together on weekends to play board games, order food, and share stories about our cultures and childhoods.”

– Bhavika S., Post-Bacc Diploma in Health and Social Impact, '25



## Lakers Support Lakers

From the moment you step into residence at Nipissing University, you're part of a vibrant community filled with helpful and caring student leaders. Residence Dons are supportive and fun upper-year students who organize events, monitor community safety, and offer a helping hand around-the-clock. Community Assistants are upper-year students who help students take accountability for, and positively contribute to, the residence community. Academic Dons help you build your academic skills outside the classroom, and the Residents' Council Executives advocate on your behalf and lead exciting events.

## Service is a Step Away

Every residence building features its own Front Desk Office with services, resources, and supports available to every resident. From laundry change and printing your essays, to borrowing a board game, asking a question, or grabbing some dish soap or study supplies, Front Desk Staff are here for you! Other Professional Staff, like Residence Life Supervisors, provide extra guidance and personal support to help you succeed, while our dedicated Maintenance Team responds to your maintenance requests and keep our residences clean.

## Guaranteed Single Rooms in Residence

If you are a current secondary school student who receives full-time admission by **May 28, 2026**, and you meet the residence application and deposit deadline of **June 1, 2026**, you are guaranteed a single room in a suite-style residence. Each fully-furnished suite accommodates four students and features:

- 4 private bedrooms
- Kitchen with fridge and stove
- Furnished dining area and living room
- 2 full bathrooms
- Wireless and wired high-speed internet access
- Access to laundry room, lounges, studies, and games room

[nipissingu.ca/residence](http://nipissingu.ca/residence)

📷 @NUResidence

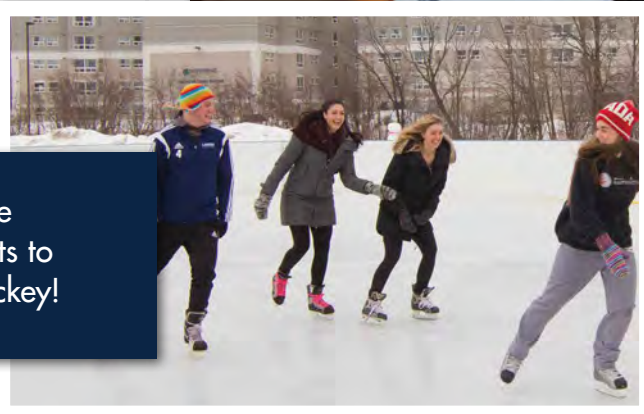

When the weather gets cold enough, the residence skating rink is flooded for students to skate for fun or play a friendly game of hockey!

# Suite-Style Residences

sample layout

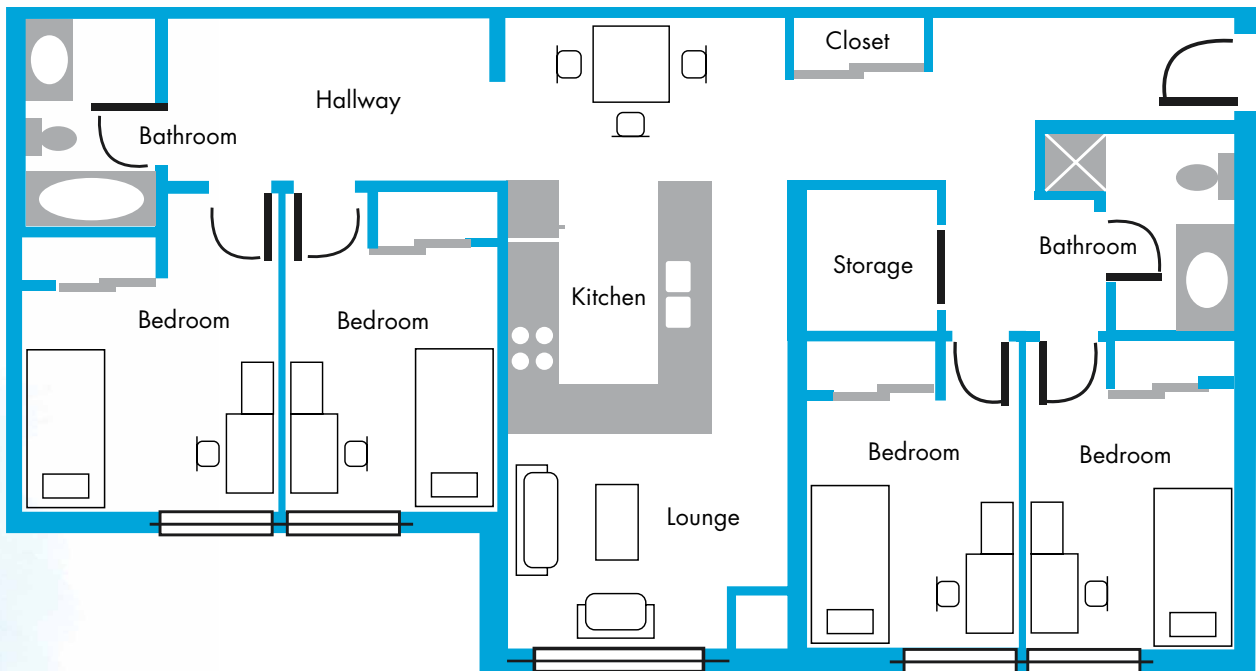

Residences are all a short walk to class, or a quick bus ride. See page 29 for a campus map.



**Governors House**



**Chancellors House**



**Founders House**



## Townhouse Residence Complex (TRC)

These residences are usually reserved for upper-year students. The TRC is located beside the main academic building at the top of College Drive and accommodates six students to a house. Built on two levels, each fully-furnished townhouse has:

- 3 private bedrooms and half bathroom on the main floor
- 3 private bedrooms and a full bathroom on the upper level
- Kitchen with fridge and stove
- Dining area
- Living room and loft

## Off Campus Living

Off Campus Living (OCL) supports Nipissing University students who are considering living or currently living off campus through educational content, digital resources, workshops, and assistance in connecting with local rentals.

[offcampusliving@nipissingu.ca](mailto:offcampusliving@nipissingu.ca)  
[ocl.nipissingu.ca](http://ocl.nipissingu.ca)

📍 @offcampuslivingnucc

Residence events and activities help you form lifelong friendships and build a supportive network.



# Finance Your Education



## If you get the marks, you get the money!

Your final grades make a big difference. Scholarship averages are calculated using your best six final 4U/4M marks<sup>†</sup> completed as of June 30, 2026. All Canadian and international applicants applying directly from secondary school for September entry will be considered automatically for guaranteed entrance scholarships – no application needed!

The chart below outlines the 2025-2026 guaranteed entrance scholarships. Please visit [nipissingu.ca/entranceawards](https://www.nipissingu.ca/entranceawards) for the most up-to-date entrance awards information or email [finaid@nipissingu.ca](mailto:finaid@nipissingu.ca)

## Guaranteed Entrance Scholarships

**No application needed!**

Scholarship Average <sup>†</sup>	Year 1	Year 2*	Year 3*	Year 4*	Total Scholarship Value
<b>95% +</b> (39+ for IB)	<b>FREE TUITION</b>	<b>FREE TUITION</b>	<b>FREE TUITION</b>	<b>FREE TUITION</b>	<b>&gt;\$23,000</b>
<b>90-94%</b> (36-38 for IB)	\$2,500	\$2,500	\$2,500	\$2,500	\$10,000
<b>85-89%</b> (33-35 for IB)	\$1,500	\$1,500	\$1,500	\$1,500	\$6,000
<b>80-84%</b> (30-32 for IB)	\$1,000	\$1,000	\$1,000	\$1,000	\$4,000

### Notes:

- Free tuition is based on domestic tuition rate and 100% course load.
- Students are only eligible for the first four years of undergraduate study.
- Concurrent BEd students in years 5 and 6 of study, and Consecutive BEd students in the 2-year program are not eligible for the renewal of these scholarships.

<sup>†</sup> Average based on the best six final 4U/4M courses (or provincial or international equivalent) or final IB score (including bonus points). See page 33 for Canadian admission requirements outside Ontario.

\* Based on cumulative GPA (CGPA) as recorded on April 30th. Students must enroll in no less than 24 credits annually to retain scholarship eligibility.



## Awards and Bursaries

Apply for all high school entrance awards and bursaries with just one application, **even before you've received your Offer of Admission.**

Complete and submit the application form by May 1, 2026 at [nipissingu.ca/entranceawards](http://nipissingu.ca/entranceawards).

There are a number of awards and bursaries based on unique criteria:

- Financial Need
- Demonstrated Citizenship
- Volunteerism
- Your Program of Interest
- Home Town



### **\$10,000** Chancellor's Awards

- Awarded to two first-year students
- Entering full-time undergraduate studies (first entry only)
- Minimum average of 85%, evidence of personal leadership activities and financial need
- Renewable at \$3,000 per year

### **\$500 – \$3,000+** Entrance Bursaries and Awards

- Need-based awards and bursaries
- Entering undergraduate studies directly from secondary school

For a complete list of scholarships, awards, bursaries, and other funding options, visit [nipissingu.ca/bursaries](http://nipissingu.ca/bursaries).

Nipissing has over **\$4.5M** in scholarships, bursaries and awards available for students

## On-Campus Employment Opportunities

Nipissing University offers the NUWork program that enables students to work part-time on campus. The majority of positions begin in September, so students are encouraged to apply in August. It is expected that students will have explored all possible funding options, including OSAP, before applying for this program. Find applications and more information at [nipissingu.ca/nuwork](http://nipissingu.ca/nuwork).

## OSAP and External Funding

Apply for government grants and loans through the Ontario Student Assistance Program (OSAP) at [ontario.ca/OSAP](http://ontario.ca/OSAP) or check out resources for external funding here: [nipissingu.ca/sfs/external-funding-budgeting-tools](http://nipissingu.ca/sfs/external-funding-budgeting-tools)

To qualify for an NUWork position, you need to demonstrate financial need, so apply for funding sources like OSAP (even if you don't receive or accept it).

# Financial Planning

A plan helps you achieve your goals on time and on budget. This information is provided for guidance only. The amounts below are estimated based on 2025-2026 costs of living on campus for the 8-month academic term and are subject to change from year to year. Please visit [nipissingu.ca/feesandpayments](https://nipissingu.ca/feesandpayments) for the most current information.

	Canadian Citizens or Permanent Residents	International Students
Tuition (Full-time)	\$5,781 – \$9,039	\$28,000
Ancillary Fees (includes a City of North Bay transit pass)	\$1,799	\$2,591 <sup>Δ</sup>
Residence Accommodation	\$7,116 – \$7,943 <sup>†</sup>	\$7,116 – \$7,943 <sup>†</sup>
Estimated Food Costs (approx. \$100/week)	\$3,400	\$3,400
Books and Supplies	\$725 – \$1,450	\$725 – \$1,450
Personal (does not include travel home)	\$3,500	\$3,500
<b>Total</b>	<b>\$22,321 – \$27,131</b>	<b>\$45,332 – \$46,884</b>

† Includes a refundable \$100 damage deposit.

• Optional on-campus parking (depending on lot): \$257 – \$315

Δ Includes UHIP (University Health Insurance Plan) for International Students (\$99/month x 8 months = \$792); subject to change

For more information on tuition and fees for your program of interest, visit: [nipissingu.ca/feesandpayments](https://nipissingu.ca/feesandpayments)



See Nipissing Fine Arts student artwork on Instagram:  
 @nipissingfinearts



# Dining on Campus



## Meal Plans

As a student, you have a lot on your plate and your food service team wants to help. When you purchase a meal plan, you can dine and save, and they'll take care of the menu planning, grocery shopping, cooking and cleanup – all you have to do is show up with an appetite!

Visit [nipissingu.ca/diningoncampus](http://nipissingu.ca/diningoncampus) to learn more.

## Fresh Food to Fuel Your Success

Nipissing's main cafeteria features a variety of food options to satisfy any appetite, including vegetarian, vegan or plant-based menu items. From scratch-made soups and globally-inspired dishes, to gourmet sandwiches and made to order entrées, you're sure to find the perfect meal or snack to suit your taste. Dine on-site or choose from a variety of convenient takeaway options.

Familiar favourites including, Pizza Pizza, Subway and We Proudly Serve by Starbucks coffee are also available. Additionally, we are pleased to offer Spirit Bear Coffee, a Fairtrade Certified and Certified Organic coffee brand with Indigenous roots. Students can also enjoy freshly made fare at the NUSU Student Centre on bar nights and at other special events throughout the year.

## Athletics Centre Canteen

Located in the R.J. Surtees Student Athletics Centre, the canteen offers grab-and-go snacks and refreshments for you to enjoy while taking in a Lakers game.

For more details on all food offerings, visit [nipissingu.ca/diningoncampus](http://nipissingu.ca/diningoncampus).





# About North Bay

City with a view

The City of North Bay, Ontario, is nestled between Lake Nipissing and Trout Lake and is surrounded by numerous protected natural areas, heritage forest parks and historical sites. Approximately a 3½ hour drive from Toronto or a 4-hour drive from Ottawa, our friendly and inviting city is a popular year-round destination. Offering plenty of activities, amenities and services to meet your student needs, North Bay's vibrancy is only exceeded by its hospitality.

Getting around town is easy with your full-time student card which doubles as a city bus pass.

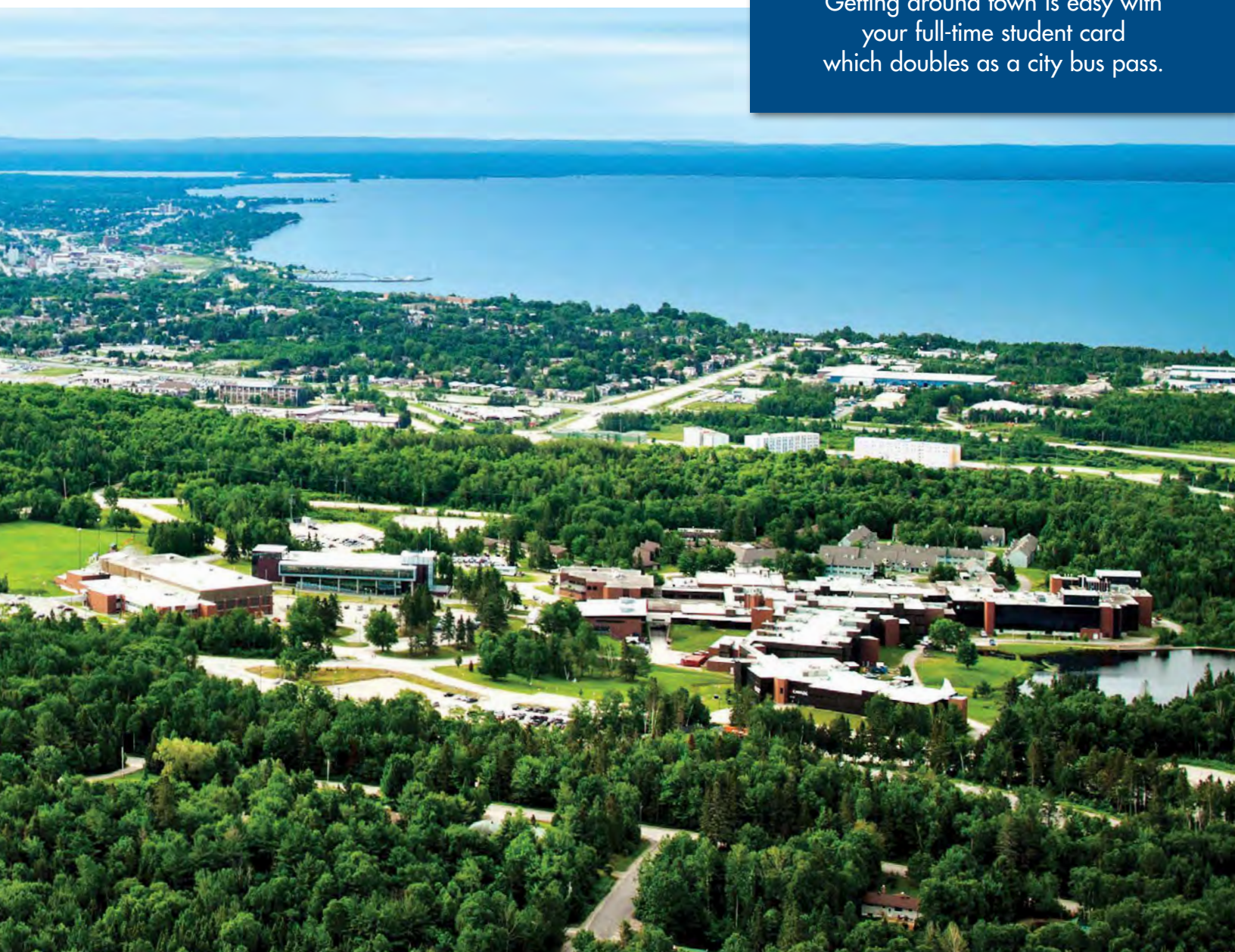

North Bay sits on the territory of Nipissing First Nation, the territory of the Anishnabek, within lands of the Robinson Huron Treaty of 1850. We are grateful to be able to live and learn on these lands with all our relations.



## North Bay Recreation

In addition to the activities available to you on campus, North Bay offers so much more:

- YMCA with pool
- Arenas (Memorial Gardens hosts our local OHL team, the Battalion)
- Shopping malls, local businesses
- Restaurants, cafes and bars
- Downhill ski and snowboarding hills (one in the city, and a second within a 45 minute drive)
- Nordic Ski Clubs
- Biking paths, all-wheel park and walking trails
- Golf courses, golf simulators and tennis courts
- Public beaches ideal for swimming and canoeing
- Beach volleyball courts and basketball courts
- Capitol Centre (features theatre performances and concerts)
- Art galleries
- North Bay Museum
- Community festivals and events
- Transportation via city bus, taxi or online ride service

There is never any shortage of things to do around North Bay.

Visit [tourisminorthbay.com](http://tourisminorthbay.com) to explore activities, attractions, events, and more.



## North Bay at a glance: [nipissingu.ca/discover-north-bay](http://nipissingu.ca/discover-north-bay)

- Hike to Duchesnay Falls, or in winter, go snowshoeing or skiing on the campus trails
- Ski hill and terrain park within city limits
- North Bay is host to many different festivals and events throughout the year, including Pride



**52,662**  
population of  
North Bay (2021)

Campus sits on  
**720**  
acres of Canadian  
Shield forest

**17.5 km**  
of paved multi-use  
trails throughout  
the city

# Your Campus Community

NIPISSING UNIVERSITY STUDENT UNION



At Nipissing, you're part of a vibrant, welcoming community built on connection, support and belonging. Small class sizes create space for big conversations, where professors know your name and are genuinely invested in your success. Beyond the classroom, the possibilities are endless - join clubs, discover new interests and build lasting friendships. At Nipissing, your journey is uniquely yours, but you'll never walk it alone. We can't wait to see where your NU adventure takes you.

## Nipissing University Student Union (NUSU)

[hello@nusu.com](mailto:hello@nusu.com) • 705-474-3450 ext. 4801 • [nusu.com](http://nusu.com) • [f](#) [d](#) [@](#) @NUSUtalks

Being away from home or starting a new chapter in life can be both exciting and challenging. At the Nipissing University Student Union (NUSU), we are dedicated to ensuring you are supported through academic excellence and social growth. NUSU is run by four elected student Executives who work with staff to represent all Nipissing students, including on-campus and distance students. Being involved on and off campus is one of the best ways to make the most of your university experience.

As an elected Board, NUSU Executives and Directors provide a full range of services (financial and academic), activities, academic and political advocacy, and events to improve the student experience, including:

- NUSU Student Centre
- Health and Dental Plan
- Food Pantry
- Student Groups (Clubs and Societies)
- Community Involvement
- OWLS Week
- Volunteer and Employment Opportunities
- Academic and Government Advocacy

**88%** of Nipissing students  
come from outside of  
North Bay



Many programs have student societies and academic clubs that offer great opportunities for professional networking, friendship and personal growth. Learn more during New Student Orientation.





To find out how you can get involved, visit [nusu.com](http://nusu.com)

## The NUSU Student Centre

Situated at the corner of College Drive and Monastery Road, the Nipissing University Student Union (NUSU) Student Centre is a defining feature on the approach to campus, welcoming students and visitors while symbolizing the importance of the student body at Nipissing University.

This building features study nooks, a two-storey atrium, nightclub, courtyard, outdoor patio, and study rooms. The Student Centre is used for both social and academic purposes. This 32,000 square-foot structure is a great place to study, connect, make memories, and attend events and seminars. We look forward to seeing you there!



## On The Rocks

On the Rocks is our student nightclub, where students can enjoy a fun night out with friends and create positive memories during their time at Nipissing University. We partner with House Party and feature DJs throughout the year.

To stay up to date on events, follow us on Instagram @ [@ontherocks.nb](https://www.instagram.com/ontherocks.nb) or Facebook at [On The Rocks North Bay](https://www.facebook.com/OnTheRocksNorthBay).





# Athletics



## Robert J. Surtees Student Athletics Centre

Whether you are a varsity student-athlete, gym enthusiast or weekend warrior, our state-of-the-art athletics centre offers everything you need to stay active. The building is located in the heart of campus next to our artificial turf field and beach volleyball courts, making it easy to cheer on our Lakers student-athletes.

- 3 Gymnasiums
- 2 International Squash Courts
- 2 Fitness Rooms
- Cardio Studio
- Weight Room
- Artificial Turf Field
- Beach Volleyball Courts
- 20 km of Hiking and Snowshoe Trails
- Groomed Nordic Ski Trails



Membership is included in your student fees.

**Did you know?**  
Ringette was invented in North Bay by Sam Jacks in 1963



## Sports Teams

For a complete list of sports and details on how to register, visit [nulakers.ca](http://nulakers.ca)

### Intramural Sports

Exercise and healthy competition always help to clear the mind. Nipissing's Athletics Department offers a wide range of intramural activities to keep you on your game. Teams include:

- Basketball
- Dodgeball
- Slo-Pitch
- Soccer
- Volleyball
- Ultimate Frisbee

To get in touch with a coach for athletic recruitment, visit: [nipissingu.ca/lakersrecruitment](http://nipissingu.ca/lakersrecruitment)

### Club Sports

Club sports are available to all Nipissing students and are both recreational and competitive.

- Cheerleading
- Women's Ringette
- Dance Pak

### Varsity-Club Sports

- Men's Lacrosse

### Varsity Teams

Go Lakers! Our varsity student-athletes always bring their A-game. Get your friends together and come out to cheer on your favourite teams.

We have both men's and women's varsity teams competing at the OUA level in:

- Basketball
- Cross-Country Running
- Hockey
- Nordic Skiing
- Rowing
- Soccer
- Volleyball



Thanks to the generous contributions of our donors, the multi-use turf field meets FIFA standards and is located adjacent to the R.J. Surtees Student Athletics Centre.





# Student Services and Support



You can count on our support – academically, culturally and personally. Student Development and Services and our other student supports are excellent resources that will help you maximize your success.

## Academic Advising

[nipissingu.ca/academicadvising](http://nipissingu.ca/academicadvising)

Our primary focus is to enhance your learning experience and development. We will help you:

- Plan your programs and advise you on any academic matters
- Choose courses and clarify academic procedures or regulations
- Make informed decisions regarding your academic priorities and goals

## Access and Belonging

[sds@nipissingu.ca](mailto:sds@nipissingu.ca)

The new Access and Belonging department within Student Development and Services reflects Nipissing University's commitment to equity and inclusion. It offers a range of support services, including the Student Support Navigator and the Sexual Violence Prevention and Education team, to foster a campus where everyone feels valued, supported, and connected. The department also features the Care and Connect Centre - a welcoming space for conversation and access to essentials like food and hygiene items, ensuring that students have what they need to thrive both personally and academically.

## Accessibility Services

[sas@nipissingu.ca](mailto:sas@nipissingu.ca) • [nipissingu.ca/sas](http://nipissingu.ca/sas)

Student Accessibility Services (SAS) supports students with permanent and temporary disabilities and strives to provide an accessible, barrier-free learning environment. If you have (or suspect that you have) a disability, we encourage you to contact us and our staff will be pleased to discuss academic accommodations and services available to support your academic and personal success.



Everyone is welcome to attend and participate in the annual Powwow in September. Celebrate and share Indigenous culture and the diversity of our community.



## Enji giigdoyang, the Office of Indigenous Initiatives

[indigenousprograms@nipissingu.ca](mailto:indigenousprograms@nipissingu.ca) • [nipissingu.ca/indigenous](http://nipissingu.ca/indigenous)

In the Nbisiing dialect of Anishnaabemwin, *Enji giigdoyang* means “Where we come to meet, discuss and talk about things.” We welcome students from a diverse community of Indigenous learners (First Nation, Metis and Inuit) to find on-campus community and belonging where we honour one another’s life experiences. Within this intergenerational learning space, programs and services are designed with Indigenous students in mind and complement your educational experience, wellness and identity. We value Indigenous knowledges, histories and voices, and build meaningful relationships with one another through a Sweetgrass Approach to Indigenous Student Success.



We offer:

- Inclusive Student Gathering Spaces
- Access to Cultural Development Activities and Funds
- Indigenous Student Mentorship
- Indigenous Cultural Arts
- Academic Tutoring and Workshops
- Dedicated Indigenous Student Success Staff
- Visiting Elder and Knowledge Holder Campus and Community Initiatives
- Experiential Learning Opportunities

## Harris Learning Library

[nipissingu.ca/library](http://nipissingu.ca/library) • [libraryhelp@nipissingu.ca](mailto:libraryhelp@nipissingu.ca)  
705-474-3450 ext. 4222

The Harris Learning Library is your gateway to library services, online instructional tutorials and information resources including electronic and print books, articles and streaming videos. Information resources can be accessed through Omni ([nipissingu.ca/omni](http://nipissingu.ca/omni)), an easy to use academic search tool that provides access to over 23 million items from 19 of Ontario’s university libraries. Friendly and knowledgeable staff members provide help in person, by email or phone whether you are on campus, studying online, or at a distance. For those not on campus, further information is available here: [nipissingu.ca/library](http://nipissingu.ca/library)

## Health Centre

[nipissingu.ca/healthcentre](http://nipissingu.ca/healthcentre) • 705-618-7233

Canadian Shield Health Care Services provides primary health care services to students and their immediate family members. The clinic operates weekdays with additional appointment times on evenings and weekends.

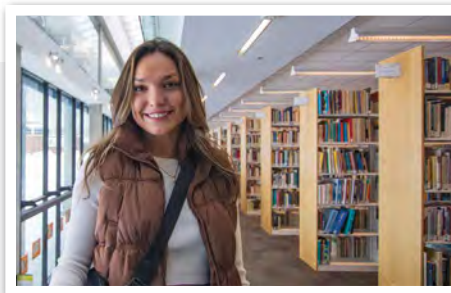

Therapy dog visits  
reduce stress.

# International Student Support (ISS)

[internationalstudent@nipissingu.ca](mailto:internationalstudent@nipissingu.ca) • [nipissingu.ca/international](http://nipissingu.ca/international)

The International Student Support (ISS) Department provides support services and programs to assist with intercultural development and integration for international students who come to Nipissing to earn their degree and for those who are here for an exchange or study abroad program.

If you are interested in internationalizing your degree at home, you can volunteer with the International Student Mentorship Program (ISMP) to help international students adjust to living and learning in Canada. You can also join the Nipissing Local Committee for the World University Service of Canada (WUSC) to work with a group of internationally minded individuals both on-campus and across Canada who believe "Education Changes the World" and have a passion to give back globally.

## Study Abroad

[internationalmobility@nipissingu.ca](mailto:internationalmobility@nipissingu.ca) • [nipissingu.ca/international](http://nipissingu.ca/international)

Internationalize your degree by studying abroad! We offer support services and programs to assist with intercultural development and integration, creating experiences that foster global citizenship.

Upper-year students can take advantage of our exchange partnerships with institutions in Australia, Barbados, Brazil, Costa Rica, Ecuador, Finland, France, Germany, Ireland, Japan, Netherlands, Norway, Philippines, South Korea, Sweden and the United Kingdom.



Study abroad at one of our partner schools around the world.

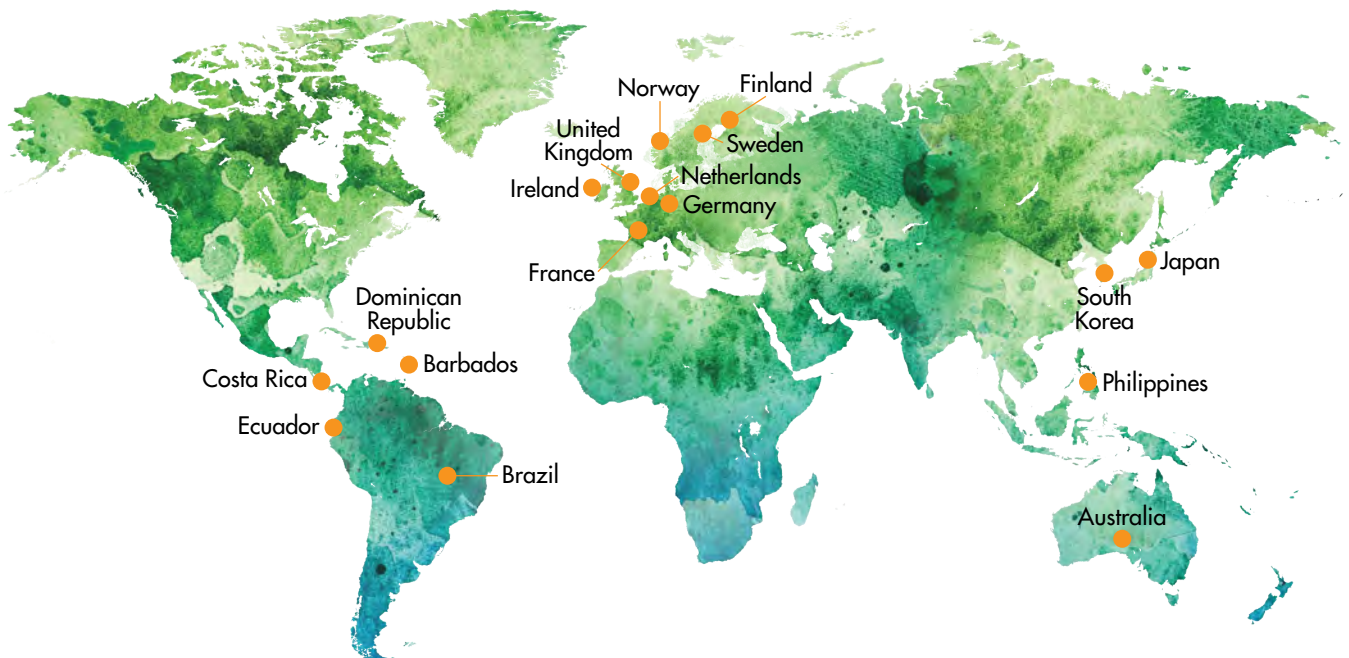



## Mental Health and Wellbeing

[mhwellbeing@nipissingu.ca](mailto:mhwellbeing@nipissingu.ca) • [nipissingu.ca/mhwellbeing](http://nipissingu.ca/mhwellbeing)

Nipissing University's Mental Health and Wellbeing department provides support to help students thrive. Many pathways to mental and emotional wellbeing are available to students including outreach events, self-help services, peer support, brief individual counselling, specialized therapeutic groups, Dibaadan Indigenous wellness support, referral, and case management. We endeavour to support students in achieving positive mental and emotional wellbeing.

## Multi-Faith Space

Room H340

With a diverse community studying and working at Nipissing, the University has developed the Multi-Faith Space, offering an inclusive space on campus for people to practice all religions. The neutral environment allows for a comfortable place for prayer, meditation and reflection.

## Sexual Violence Prevention and Education

[svsupport@nipissingu.ca](mailto:svsupport@nipissingu.ca) • [nipissingu.ca/sexualviolence](http://nipissingu.ca/sexualviolence)

Nipissing University is committed to creating and maintaining a safe environment for all students. Survivors are offered navigation of services on and off campus, assistance with arranging academic accommodations and help understanding reporting options. Additionally, there are free workshops on consent, healthy relationships and bystander intervention for all students.

## Student Learning and Transitions

[slt@nipissingu.ca](mailto:slt@nipissingu.ca) • [nipissingu.ca/slt](http://nipissingu.ca/slt)

Student Learning and Transitions (SLT) focuses on supporting students from orientation to graduation in the areas of academic skill development and the student experience. We provide one-on-one academic consultations, group workshops and tutorials, peer-to-peer support and tutoring, subject-specific resources, and referral points for all students. Our transition programs focus on the multiple changes that occur throughout a student's post-secondary experience and include facilitated programs, campus activities, career services support, and events that promote academic and social integration, while preparing students for future goals beyond graduation.





# Campus Map

We are proud to share our campus with Canadore College, which adds to the vibrancy of our campus community.

For virtual tours, our interactive map, or to book an in-person tour of our beautiful campus, visit: [nipissingu.ca/visitus](http://nipissingu.ca/visitus)

Getting around campus is easy! It's a quick walk between buildings or hop on the bus to come up the hill from Founders and Chancellors residences.





- 1 Nipissing Main Building
- 2 Harris Learning Library
- 3 R.J. Surtees Student Athletics Centre
- 4 Governors Residence
- 5 Townhouse Residence Complex (TRC)
- 6 Founders Residence
- 7 Chancellors Residence
- 8 Monastery Hall (Fine Arts)
- 9 Paths to 20 km of Trails
- 10 Turf Field and Beach Volleyball Courts
- 11 NUSU Student Centre
- 12 Canadore College
-  City Bus Stop

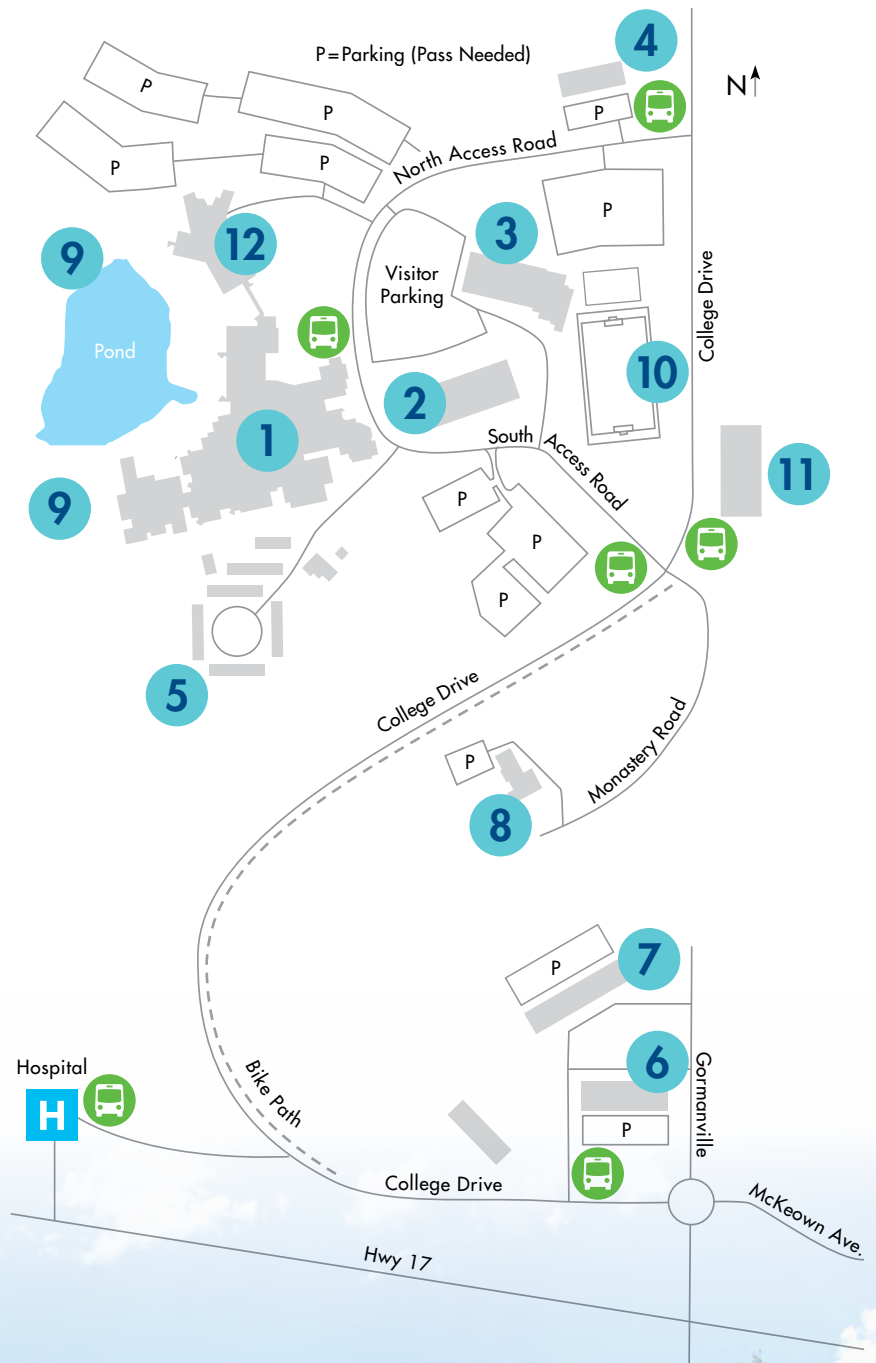

**20km**  
of hiking/Nordic ski  
trails on campus



# Apply for Admission

To be considered for full-time admission to an Ontario university, prospective students can apply to the Ontario Universities' Application Centre (OUAC) at [ouac.on.ca](http://ouac.on.ca).

You will receive a confirmation email from Nipissing once your application has been received.

## Your Application Timeline

**Jan. 15, 2026**

### Ontario Deadline to Apply to University

**Ontario secondary school students** are expected to submit application forms to the Ontario Universities' Application Centre (OUAC) by this date.

**Dec. - May**

### Offers of Admission Sent Out

Offers of Admission are made on a rolling basis as grade information is received with most decisions being released within the following admission rounds.

**Round #1<sup>1</sup>** – Beginning of December

**Round #2<sup>2</sup>** – Beginning of March

**Round #3** – Beginning of May

A final round will take place at the end of July provided room remains in the programs applicants applied to.

- <sup>1</sup> A limited number of offers to limited enrollment programs (Physical and Health Education, Nursing, History with an Orientation to a Master of Arts in History) will be released at this time.
- <sup>2</sup> Offers to limited enrollment programs for applicants who applied by the equal consideration deadline will start being released.

**Feb. 16, 2026**

### Equal Consideration Deadline for Limited Enrollment Programs

Applications to Nursing, Physical and Health Education, and History with an Orientation to a Master of Arts in History are highly competitive programs that typically have more qualified applicants than space available.

Applicants who apply by this deadline and submit all documentation by **February 27** will receive equal consideration for admission with all other applicants.

#### **Ontario secondary school students**

Ensure that your OUAC application shows proof of registration in six 4U/4M courses, including prerequisites subjects by **February 27**.

#### **Canadian secondary school students from outside Ontario**

Ensure that Nipissing has received an official transcript showing all completed high school courses by **February 27**. If in progress courses and/or midterm grades cannot be listed on an official transcript, have your guidance counsellor send the courses/grades in an email to [admissions@nipissingu.ca](mailto:admissions@nipissingu.ca). In addition, applicants must have completed or be registered in the appropriate number of courses required for admission consideration for their province, including prerequisite subjects.

#### **Missed the deadline?**

Programs may continue to accept applications after this date. Qualified applicants will continue to be considered for admission provided room remains in the program, otherwise a position on the waiting list may be offered.



## April 1, 2026

### Application Deadline

#### Ontario secondary school students

- Nipissing continues to accept new applications between **January 15 and April 1**.
- Submit any changes to your program choices by this date.

#### Canadian secondary school students from outside Ontario

- Submit all applications to the Ontario Universities Application Centre (OUAC) by this date.

#### International students

- If you are an international student studying in Canada (on a study permit) or studying in another country (no status in Canada), you should apply using the Nipissing International Application portal. See page 32 for further information.

#### Missed the deadline?

- Late applications may be considered after **April 1**.

## May 1, 2026

### Entrance Awards/Scholarships Application Deadline

Apply for scholarships, awards and bursaries **before** receiving your Offer of Admission. To find application forms, visit [nipissingu.ca/studentfinancialservices](http://nipissingu.ca/studentfinancialservices).

## May 28, 2026

### Response Date

Secondary school applicants who applied by the January deadline should receive one of the three responses from Nipissing by this date:

1. Offer of Admission to your program of choice or an Alternate Offer; or
2. Delay of decision notification pending your response to our letter of request for specific additional information; or
3. Refusal.

Secondary school students receiving a full-time Offer of Admission by this date are eligible for a guaranteed spot in residence.

## June 1, 2026

### Accept Our Offer of Admission by this Date

Accept our Offer of Admission on the Ontario Universities' Application Centre (OUAC) website.

### Residence Application Form and Deposit Deadline

Secure your spot in residence by submitting your residence application form and deposit early. Current secondary school students are guaranteed a placement with a completed application and deposit submitted by this date.

The Offer of Admission package you received from us provides instructions on how to apply and make online payments.

Requests for special accommodations in residence should be completed by this date through the Accessibility Services Office.

Visit [nipissingu.ca/applytoresidence](http://nipissingu.ca/applytoresidence) to learn more.

If you have admissions questions, contact [admissions@nipissingu.ca](mailto:admissions@nipissingu.ca) or call 705-474-3450 ext. 4600



# Applying to Study Full-Time

## How to Apply

Canadian applicants (citizen or permanent resident)	
Ontario secondary school students	<p align="center"><b>OUAC Undergraduate Application</b> Apply through the Ontario Universities' Application Centre (OUAC) Apply by visiting <a href="http://ouac.on.ca">ouac.on.ca</a></p>
Students attending Canadian secondary schools outside Ontario	
Applicants not currently attending a Canadian Secondary School	
International applicants (studying in Canada on a study permit or studying in another country with no current status in Canada)	
Students attending an Ontario curriculum secondary school	<p align="center"><b>OUAC Undergraduate Application</b> Apply by visiting <a href="http://ouac.on.ca">ouac.on.ca</a></p>
Students attending a Canadian curriculum secondary school (other than Ontario)	<p align="center"><b>Nipissing International Application</b> Apply by visiting <a href="http://nipissingu.ca/applyintl">nipissingu.ca/applyintl</a></p>
All other international applicants	
Please visit <a href="http://nipissingu.ca/intl">nipissingu.ca/intl</a> or email <a href="mailto:internationaladmiss@nipissingu.ca">internationaladmiss@nipissingu.ca</a> for more information.	

## Canadian Secondary School Applicants

Applying to your program of interest at Nipissing is simple – there are no hidden formulas. A minimum average of 80% is required for History with an Orientation to a Master of Arts in History. A minimum average of 70% is required for consideration for admission to all other programs. Averages for all programs are based on your best six final 4U/4M or equivalent courses including all required courses. Please refer to the Admissions Chart on page 36 for specific course requirements. For general admission requirements for all Canadian provinces and territories, see the next page. The chart also outlines each provincial/territorial high school course that Nipissing University will accept as equivalent to the specific Ontario program prerequisites.

For more information, visit [nipissingu.ca/cssapplicants](http://nipissingu.ca/cssapplicants).

## International Baccalaureate

Applicants who have successfully completed the International Baccalaureate (IB) diploma with at least six subjects, including three at a higher level, with a minimum final grade of 24, will be considered for admission. Students who successfully complete the International Baccalaureate (IB) diploma with a score of 24 or higher are eligible to receive up to 30 transfer credits, equivalent to one year of full-time study. Eligibility will be considered for all IB courses (higher and standard level) completed with a score of 5 or higher. Students are also eligible to receive transfer credit for individual higher and standard level IB courses completed with a score of 5 or higher.

For more information, visit [nipissingu.ca/baccalaureate](http://nipissingu.ca/baccalaureate).

## Advanced Placement

Applicants who have completed Advanced Placement (AP) courses are encouraged to submit their examination results. Official AP score reports must be sent directly to Nipissing University. Advanced standing will be granted for most AP courses completed with a grade of 4 or higher, to a maximum of 18 credits. Nipissing's College Board number is 4149. For more information, visit [nipissingu.ca/advancedplacement](http://nipissingu.ca/advancedplacement).

## Proof of Proficiency in English

All applicants to Nipissing University undergraduate degree and post-baccalaureate programs (excluding BEd) from countries where the dominant language of instruction is other than English will be required to submit results of an English language proficiency test and reach the required proficiency level for admission consideration. Permanent Resident applicants whose first language is not English may be required to provide proof of proficiency in English. Permanent Resident applicants whose first language is not English but who have lived at least three years in Canada, or a country where English is the dominant language may be exempt. Nipissing's full policy including minimum test scores and exemption policy can be found at [nipissingu.ca/englishproficiency](http://nipissingu.ca/englishproficiency).



# Out-of-Province Admission Requirements

This table shows the high school courses for all provinces and territories that are equivalent to the admission requirements for Ontario students. Admission requirements for Ontario students can be found on the next page.

Please visit [nipissingu.ca/canadianhsapplicants](http://nipissingu.ca/canadianhsapplicants) for more information.

Ontario	General Requirements	English 4U	Biology 4U	Chemistry 4U	Physics 4U	Calculus and Vectors 4U	If Advanced Functions 4U or 4U Mathematics is required	Introduction to Kinesiology 4U
Alberta/ NWT/Nunavut	Secondary School Diploma with five academic Grade 12 courses numbered 30 or 31 including program specific prerequisites.	English 30 or ELA 30-1	Biology 30	Chemistry 30	Physics 30	Math 31	Math 30-1 or Math 30-2 (Math 30-1 must be presented if Advanced Functions is specifically stated)	N/A
British Columbia/ Yukon	Secondary School Diploma with four academic level Grade 12 courses (courses with % grades not letter grades) including program specific prerequisites. Provincial exams are not required.	English 12 or English 12: First Peoples	Biology 12 or Anatomy and Physiology 12	Chemistry 12	Physics 12	Calculus 12	Foundations of Math 12 or Pre-Calculus 12 (Pre-Calculus 12 must be presented if Advanced Functions is specifically stated)	N/A
Manitoba	Secondary School Diploma with five academic 40 level courses including program specific prerequisites.	English Language Arts 40S	Biology 40S	Chemistry 40S	Physics 40S	Calculus 45A or 45S	Applied Math 40S or Pre-Calculus 40S (Pre-Calculus 40S must be presented if Advanced Functions is specifically stated)	N/A
New Brunswick	Secondary School Diploma with five academic Grade 12 courses number 121 or 122 (courses numbered 120 may be considered) including program specific prerequisites.	English 121 or 122	Biology 121 or 122	Chemistry 121 or 122	Physics 121 or 122	Calculus 120	Foundations of Math 120 or Pre-Calculus A120 or B120 (Pre-Calculus A120 or B120 must be presented if Advanced Functions is specifically stated)	N/A
Newfoundland	Secondary School Diploma with six two-credit academic courses at level 3000 including program specific prerequisites.	English 3201	Biology 3201	Chemistry 3202	Physics 3204	Calculus 3208	Advanced Math 3200 or Math 3201 (Advanced Math 3200 must be presented if Advanced Functions is specifically stated)	N/A
Nova Scotia	Secondary School Diploma with five academic or advanced Grade 12 courses including program specific prerequisites.	English 12 or English 12: African Heritage	Biology 12	Chemistry 12	Physics 12	Calculus 12	Math (Academic) 12 or Pre-Calculus 12 (Pre-Calculus 12 must be presented if Advanced Functions is specifically stated)	N/A
Prince Edward Island	Secondary School Diploma with five academic Grade 12 courses numbered 611 or 621 including program specific prerequisites.	English 621A	Biology 621A	Chemistry 611A or 621A	Physics 621A	Math 611B	Math 621B (Math 621A may be used to satisfy a non-specific 4U Math prerequisite)	N/A
Quebec (CEGEP)*	One year of CEGEP completed with a minimum of 12 academic subjects including program specific prerequisites.	2 semester courses in English (603 or 604 series)	Biology NYA	Chemistry (NYA and NYB)	Physics (NYA and NYB)	Calculus 1 (Math NYC)	Linear Algebra (Math NYC) or Calculus 2 (Math NYB) (Linear Algebra must be presented if Advanced Functions is specifically stated)	N/A
Quebec (Private)	Secondary School Diploma with six academic Grade 12 courses including program specific prerequisites.	Grade 12 English	Grade 12 Biology	Grade 12 Chemistry	Grade 12 Physics	Grade 12 Calculus	Grade 12 Advanced Functions or Grade 12 Data Management	N/A
Saskatchewan	Secondary School Diploma with five academic Grade 12 courses at the 30 level including program specific prerequisites.	English 30A or 30B	Biology 30	Chemistry 30	Physics 30	Calculus 30	Foundations of Math 30 or Pre-Calculus 30 (Pre-Calculus 30 must be presented if Advanced Functions is specifically stated)	N/A

\* Applicants from Quebec who have completed more than one year of CEGEP (more than 12 courses) will be considered for admission with transfer credit. Applicants who have completed the DEC program at a CEGEP with a cumulative average of "B" or better will be considered for admission with transfer credit to a maximum of 30 credits. Prerequisite subjects will apply.

# Admissions Chart

The following chart lists prerequisite courses required for Nipissing University degree programs in 2026. Please note that English refers to one of ENG4U or EAE4U. Please visit [nipissingu.ca/onprogramreqts](http://nipissingu.ca/onprogramreqts) for further information.

Degree Program	OUAC Application Program Codes	Minimum Average	Majors	Required 4U or Equivalent
<b>Bachelor of Arts (BA)</b>	PA	70%	Anthropology, Child and Family Studies <sup>7</sup> , English Studies, Environmental Geography <sup>2</sup> , Gender Equality and Social Justice, Geography <sup>2</sup> , History <sup>8</sup> , Indigenous Studies, Philosophy, Political Science, Psychology <sup>7</sup> , Religions and Cultures, Social Welfare and Social Development, Sociology	English
			Computer Science <sup>5</sup> , Mathematics <sup>5</sup>	English; Calculus and Vectors; one other Mathematics
	PAJ	70%	Criminal Justice – Corrections and Community Justice Services; Criminal Justice Studies; Criminology; or Policing streams	English
	PAL	70%	Liberal Arts	English
	PAC	70%	Social Welfare and Social Development with a Social Service Worker diploma	English
PAH	80%	History with an Orientation to a Master of Arts in History	English	
<b>Bachelor of Business Administration<sup>6</sup> (BBA)</b>	PBA	70%	Students select an area of concentration at the end of first year: Accounting; Entrepreneurship and Innovation Leadership; Finance; Human Resources; International Business; Marketing	English (two Mathematics is recommended) <sup>1</sup>
<b>Bachelor of Commerce (BComm) - Distance</b>	PCO	70%	Students may select an area of concentration at the end of first year: Accounting or Human Resources	English
<b>Bachelor of Fine Arts (BFA)</b>	PFA	70%		English
<b>Bachelor of Physical and Health Education (BPHE)</b>	PPE	70%		English; one of Biology or Introduction to Kinesiology; (Chemistry and one Mathematics are recommended)

- 1 Students admitted without two 4U Mathematics or equivalent will be required to complete MATH 1911 and/or MATH 1912 in their first year.
- 2 A Certificate in Geomatics is also available to students pursuing an Honours degree in these majors.
- 3 A Certificate in Neuroscience is also available to students pursuing an Honours degree in these majors.
- 5 A Certificate in Game Design and Development is available to students pursuing a degree in these majors.
- 6 An iLEAD Business Experience Certificate is available to students pursuing one of these degrees.
- 7 A Certificate in Program Evaluation and Applied Research (PEAR) is available to students pursuing an Honours Specialization, Specialization or a Major in these areas.
- 8 A Certificate in Study of State Violence (War, Atrocity, and Genocide) is available to students pursuing a degree in these majors.
- 9 During Year 2 of the Bachelor of Social Work program, students must apply for admission consideration to the professional years (Years 3 & 4) of the program. Admission to the first or second year of the Bachelor of Social Work program does not guarantee acceptance into the professional years.



Degree Program	OUAC Application Program Codes	Minimum Average	Majors	Required 4U or Equivalent
Bachelor of Science (BSc)	PS	70%	Biology <sup>3</sup>	English; Biology; Chemistry; one of Calculus and Vectors or Advanced Functions
			Computer Science <sup>5</sup>	English; Calculus and Vectors; one other Mathematics; one of Biology, Chemistry or Physics
			Data Science	English; Calculus and Vectors; Advanced Functions; one of Biology, Chemistry or Physics
			Environmental Biology and Technology	English; Biology; Chemistry; one of Calculus and Vectors, Advanced Functions or Physics
			Environmental Science	English; one of Calculus and Vectors or Advanced Functions; Chemistry; one of Biology, Physics or Earth and Space Science
			Environment and Physical Geography <sup>2</sup>	English; Mathematics; one of Chemistry or Physics
			Mathematics <sup>5</sup>	English, Calculus and Vectors; Advanced Functions; one of Biology, Chemistry or Physics
	Psychology <sup>3,7</sup>	English; one Mathematics; one of Biology, Chemistry or Physics		
	PLB	70%	Liberal Science	English; two of Chemistry, Mathematics (either Calculus and Vectors or Advanced Functions) or Physics
Bachelor of Science in Nursing (BScN)	PSN	70%		English; Biology; Chemistry (one Mathematics is recommended)
Bachelor of Social Work (BSW) <sup>9</sup>	PSW	70%		English (minimum grade 70%)
Bachelor of Arts (BA) or Bachelor of Science (BSc) combined with Bachelor of Commerce (BComm) <sup>6</sup>	PAB or PSS	70%		The regular requirements for the Bachelor of Arts (BA) or Bachelor of Science (BSc) major to which the person has applied.

The following Certificates are available to all students pursuing any degree:

- Applied Behavioural Sciences (ABS)
- Archaeological Monitoring
- Bilingualism
- Conflict Resolution and Negotiation
- Early Intervention
- Environmental Management
- Forest Resource Management and Conservation
- Health Studies and Gerontology
- Societies in Transition: Relationship, Reciprocity, and Reconciliation Histories

For out-of-province admission requirements, see page 33.

For international admission requirements, visit [nipissingu.ca/intl](http://nipissingu.ca/intl).

# Admissions Chart – Concurrent Education Programs

Degree Program		OUAC Application Program Codes	Minimum Average	Majors	Required 4U or Equivalent
<b>Concurrent Bachelor of Arts (BA)/ Bachelor of Education (BEd)</b>	Primary/Junior Junior/ Intermediate Intermediate/ Senior	PE PEA PEB	70%	Anthropology <sup>11</sup> , Child and Family Studies <sup>7</sup> , English Studies, Environmental Geography <sup>2</sup> , Gender Equality and Social Justice, Geography <sup>2</sup> , History <sup>8</sup> , Indigenous Studies <sup>11</sup> , Philosophy, Political Science, Psychology <sup>7</sup> , Religions and Cultures <sup>11</sup> , Social Welfare and Social Development, Sociology	English (minimum grade of 70%); one 3U, 3M, or 4U Mathematics (minimum grade of 60%)
				Computer Science <sup>5</sup> , Mathematics <sup>5</sup>	English (minimum grade of 70%); Calculus and Vectors; one other Mathematics (4U Mathematics courses are required for admission and a minimum grade of 60% must be achieved in one of 3U, 3M or 4U Mathematics)
	Primary/Junior Junior/ Intermediate Intermediate/ Senior	PED PEF PEG	70%	Criminal Justice – Corrections and Community Justice Services; Criminology; or Policing streams	English (minimum grade of 70%); one 3U, 3M, or 4U Mathematics (minimum grade of 60%)
<b>Concurrent Bachelor of Business Administration (BBA)<sup>6</sup> / Bachelor of Education (BEd)</b>	Primary/Junior Junior/ Intermediate Intermediate/ Senior	PEL PEM PEN	70%	Students select an area of concentration at the end of first year: Accounting; Entrepreneurship and Innovation Leadership; Finance; Human Resources; International Business; Marketing	English (minimum grade of 70%); one 3U, 3M, or 4U Mathematics (minimum grade of 60%); (two 4U Mathematics is recommended) <sup>1</sup>
<b>Concurrent Bachelor of Fine Arts (BFA)/ Bachelor of Education (BEd)</b>	Primary/Junior Junior/ Intermediate Intermediate/ Senior	PEH PEI PEK	70%		English (minimum grade of 70%); one 3U, 3M, or 4U Mathematics (minimum grade of 60%)

- 1 Students admitted without two 4U Mathematics or equivalent will be required to complete MATH 1911 and/or MATH 1912 in their first year.
- 2 A Certificate in Geomatics is also available to students pursuing an Honours degree in these majors.
- 3 A Certificate in Neuroscience is also available to students pursuing an Honours degree in these majors.
- 5 A Certificate in Game Design and Development is available to students pursuing a degree in these majors.
- 6 An iLEAD Business Experience Certificate is available to students pursuing one of these degrees.
- 7 A Certificate in Program Evaluation and Applied Research (PEAR) is available to students pursuing an Honours Specialization, Specialization or a Major in these areas.
- 8 A Certificate in Study of State Violence (War, Atrocity, and Genocide) is available to students pursuing a degree in these majors.
- 9 During Year 2 of the Bachelor of Social Work program, students must apply for admission consideration to the professional years (Years 3 & 4) of the program. Admission to the first or second year of the Bachelor of Social Work program does not guarantee acceptance into the professional years.
- 11 Indigenous Studies and Religion and Cultures are available to Concurrent Education students pursuing an Honours degree with a double major.

The following Certificates are available to all students pursuing any degree:

- Applied Behavioural Sciences (ABS)
- Archaeological Monitoring
- Bilingualism
- Conflict Resolution and Negotiation
- Early Intervention
- Environmental Management
- Forest Resource Management and Conservation
- Health Studies and Gerontology
- Societies in Transition: Relationship, Reciprocity, and Reconciliation Histories



Degree Program		OUAC Application Program Codes	Minimum Average	Majors	Required 4U or Equivalent
<b>Concurrent Bachelor of Physical and Health Education (BPHE)/ Bachelor of Education (BEd)</b>	Primary/Junior Junior/Intermediate Intermediate/Senior	PEO PEQ PER	70%		English (minimum grade of 70%); one of Biology or Introduction to Kinesiology; one 3U, 3M, or 4U Mathematics (minimum grade of 60%); (Chemistry and one 4U Mathematics are recommended)
<b>Concurrent Bachelor of Science (BSc)/ Bachelor of Education (BEd)</b>	Primary/Junior Junior/Intermediate Intermediate/Senior	PES PET PEU	70%	Biology <sup>3</sup>	English (minimum grade of 70%); Biology; Chemistry; one of Calculus and Vectors or Advanced Functions (4U Mathematics courses are required for admission and a minimum grade of 60% must be achieved in one of 3U, 3M or 4U Mathematics)
				Computer Science <sup>5</sup>	English (minimum grade of 70%); Calculus and Vectors; one other Mathematics; one of Biology, Chemistry or Physics (4U Mathematics courses are required for admission and a minimum grade of 60% must be achieved in one of 3U, 3M or 4U Mathematics)
				Data Science	English (minimum grade of 70%); Calculus and Vectors; Advanced Functions; one of Biology, Chemistry or Physics (4U Mathematics courses are required for admission and a minimum grade of 60% must be achieved in one of 3U, 3M or 4U Mathematics)
				Environment and Physical Geography <sup>2</sup>	English (minimum grade of 70%); Mathematics; one of Chemistry or Physics (a 4U Mathematics course is required for admission and a minimum grade of 60% must be achieved in one of 3U, 3M or 4U Mathematics)
				Environmental Biology and Technology	English (minimum grade of 70%); Biology; Chemistry; one of Calculus and Vectors, Advanced Functions or Physics (4U Mathematics courses are required for admission and a minimum grade of 60% must be achieved in one of 3U, 3M or 4U Mathematics)
				Environmental Science	English (minimum grade of 70%); one of Calculus and Vectors or Advanced Functions; Chemistry; one of Biology, Physics or Earth and Space Science (4U Mathematics courses are required for admission and a minimum grade of 60% must be achieved in one of 3U, 3M or 4U Mathematics)
				Mathematics <sup>5</sup>	English (minimum grade of 70%); Calculus and Vectors; Advanced Functions; one of Biology, Chemistry or Physics (4U Mathematics courses are required for admission and a minimum grade of 60% must be achieved in one of 3U, 3M or 4U Mathematics)
				Psychology <sup>3,7</sup>	English (minimum grade of 70%); one Mathematics; one of Biology, Chemistry or Physics (a 4U Mathematics course is required for admission and a minimum grade of 60% must be achieved in one of 3U, 3M or 4U Mathematics)

For out-of-province admission requirements, see page 33.

For international admission requirements, visit [nipissingu.ca/intl](http://nipissingu.ca/intl).

# Come for a visit and see why you belong at Nipissing U!

## Open House Events\*

Fall: Saturday, October 25, 2025

March Break: Saturday, March 14, 2026

\*Please check the website regularly for updates to events. For more information and to register for Open House, visit [nipissingu.ca/visitus](http://nipissingu.ca/visitus).

## Book Your Own Campus Tour

Can't make it to an Open House? Register for a campus tour offered throughout the week.

Visit [nipissingu.ca/visitus](http://nipissingu.ca/visitus), call 705-474-3450 ext. 4200 or email [nuinfo@nipissingu.ca](mailto:nuinfo@nipissingu.ca)



Explore our campus map with virtual tours and photos: [map.nipissingu.ca](http://map.nipissingu.ca)

Connect with us



[nipissingu.ca/futurestudents](http://nipissingu.ca/futurestudents)

[f](https://www.facebook.com/NipissingU) [x](https://www.x.com/NipissingU) [@NipissingU](https://www.instagram.com/NipissingU)

[@nipissing\\_university](https://www.youtube.com/channel/UC...)



Student Recruitment Office • 100 College Drive, Box 5002, North Bay, ON P1B 8L7  
tel: 705-474-3450 ext. 4200 • toll free (within Ontario): 800-655-5154  
[nuinfo@nipissingu.ca](mailto:nuinfo@nipissingu.ca) • fax: 705-495-1772

If you would like to request this publication in an alternative format please contact the External Relations Office at 705-474-3450 ext. 4078 or email [marketing@nipissingu.ca](mailto:marketing@nipissingu.ca)