



NIPISSING

U N I V E R S I T Y

Right where *you* belong



International Admissions 2026
nipissinglakers.com



EduCanada[®]
A world of possibilities
Un monde de possibilités



NORTH BAY & AREA
Rural Community Immigration Pilot



North Bay, Ontario, Canada

Areas of Study

Undergraduate Programs

We have a variety of options to structure and customize your degree. For admissions requirements please see page 10. For a full list of program offerings, please visit nipissingu.ca/programs

Anthropology

Biology

Business

Concentrations in: Accounting, Entrepreneurship and Innovation Leadership, Finance, Human Resources, International Business, and Marketing

Child and Family Studies

Commerce*

(only as a Dual Degree with BA or BSc)

Computer Science

Criminal Justice*

Streams in: Corrections and Community Justice Services, Criminal Justice Studies, Criminology, and Policing

Data Science

English Studies

Environment and Physical Geography*

Environmental Biology and

Technology*

Environmental Geography*

Fine Arts

Gender Equality and Social Justice

Geography

History

Indigenous Studies

Liberal Arts

Liberal Science

Mathematics

Nursing*

Philosophy

Physical and Health Education*

Political Science

Psychology

Religions and Cultures

Social Welfare and Social

Development

Social Work*

Sociology

*Not available as a minor

Average
Class Size **33**





No specific degree or major is required for Law, Medical, MBA, or Veterinary schools. Nipissing University offers all prerequisite courses required for admission to these programs.

Graduate Programs

Please note: Students interested in pursuing graduate programs should connect with sgs@nipissingu.ca and international admissions internationaladmiss@nipissingu.ca for more information about graduate programs and services available to international graduate students.

Master of Arts (History)

Master of Arts (Sociology)

Master of Environmental Science

Master of Environmental Studies

Master of Science (Kinesiology)

Master of Science (Mathematics)

Education

Concurrent Education – Dual Degree

Nipissing offers a 6-year concurrent program that lets you earn two degrees – an honours undergraduate degree in your chosen area of study (except Nursing and Social Work), and a Bachelor of Education degree.

Consecutive Education

A 2-year program for those students who have already completed a 3 or 4 year undergraduate degree.

Post-Baccalaureate Diplomas (2 year program)

Post-Baccalaureate Diplomas are available to international students who have already graduated with an undergraduate degree program from a recognized university.

Artificial Intelligence and Machine Learning Applications

Business – students may specialize in one of five areas:

- Business Administration
- Finance
- Human Resource Management
- International Business
- Marketing

Environment and Sustainability

Health and Social Impact



Supportive Professors

Finance Your Education

Your final grades make a big difference. Scholarship averages are calculated using your best six final 4U/4M marks (or provincial or international equivalent) completed as of June 30, 2025. All Canadian and international applicants applying directly from secondary school for September entry will be considered automatically for guaranteed entrance scholarships for Fall 2025 entry – no application needed!

The chart below outlines the 2024-2025 guaranteed entrance scholarships. Please visit nipissingu.ca/highschoolawards for the most up-to-date entrance awards information or email finaid@nipissingu.ca

Guaranteed Entrance Scholarships

Scholarship Average [†]	Year 1	Year 2 - Year 4*	Total Scholarship Value
95% + (39+ for IB)	\$5,700 - \$8,400**	\$5,700 - \$8,400**	>\$23,000
90-94% (36-38 for IB)	\$2,500	\$2,500	\$10,000
85-89% (33-35 for IB)	\$1,500	\$1,500	\$6,000
80-84% (30-32 for IB)	\$1,000	\$1,000	\$4,000

No application needed!

** Scholarship is based on domestic tuition rate and 100% course load and varies per program.

- Students are only eligible for the first four years of undergraduate study.
- Concurrent BEd students in years 5 and 6 of study, and Consecutive BEd students in the 2-year program are not eligible for the renewal of these scholarships.

† Average based on the best six final 4U/4M courses (provincial or international equivalent) or final IB score (including bonus points).

* Based on cumulative GPA (CGPA) as recorded on April 30th. Students must enroll in no less than 24 credits annually to retain scholarship eligibility.

Apply for a \$7,500 Schulich Scholarship

- 55 Scholarships available to BEd students entering year one of their professional years of study: **Consecutive BEd year 1** or **Concurrent BEd year 5**
- 5 scholarships for students entering **MSc Kinesiology**

Must have a minimum 80% average and at least one of the following: volunteer work; community involvement; or financial need.

Apply online at www.nipissingu.ca/schulichscholarships

- * Please note: Students applying to the 2-year Consecutive Bachelor of Education program should apply for Schulich Scholarships by Jan 15.

Other Bursaries and Awards

There are a number of other donor-established bursaries and awards for which upper year international students may qualify; to be considered, please complete the Web Bursary application that is posted on WebAdvisor (Nipissing's online student portal) the month of October.

International Work Study Program

The International Work-Study program provides part-time, on-campus employment to upper year international students who can prove financial need.

International Work-Study is not intended to provide emergency funding; rather, it is to act as a supplement to a student's finances and to provide valuable on-campus employment which is allowed via Citizenship & Immigration Canada (CIC).

Contact the International Studies Office (internationalsupport@nipissingu.ca) for more information.

Create a Financial Plan

A plan helps you achieve your goals on time and on budget. This information is provided for guidance only. These are estimated based on 2024-2025 costs of living on campus for the 8-month academic term and are subject to change from year to year. Please visit nipissingu.ca/feesandpayments for the most current information.

Visit our online calculator for tuition and living expenses: nipissingu.ca/tuition

Fees		International Student Fees
Full-time	Tuition (Full-time)	\$25,500
	Ancillary Fees (includes a City of North Bay Bus Pass)	\$1,739
Part-time	Cost per course	\$2,550
	Ancillary Fees per course	\$114
	City of North Bay Bus Pass	\$232
Other Expenses		
Residence		\$6,909 - \$7,711[†]
Personal Costs (does not include travel home)		\$3,500
Estimated Food Costs (approx. \$100/week)		\$3,400
Books and Supplies		\$650 - \$1,300
Student Health Insurance		\$371[∞]
University Health Insurance Plan		\$756^Δ
Full-time Estimated Costs		\$45,721 - \$47,173

† Includes refundable \$100 damage deposit

- Optional on-campus parking (depending on lot): \$257 – \$315

Δ UHIP (University Health Insurance Plan). UHIP is mandatory for full- and part-time international students: (\$94.50/month x 8 months = \$756); subject to change.

∞ Student Insurance Plan (SIP) is \$371 which covers Sept 1– Aug 31. Students may opt out with proof of existing insurance plan and be reimbursed.

Studying at Nipissing

North Bay

The City of North Bay, Ontario, is nestled between Lake Nipissing and Trout Lake and is surrounded by numerous protected natural areas, heritage forest parks and historical sites. Approximately a 3½ hour drive from Toronto or 4 hours from Ottawa, our friendly and inviting city is a popular year round destination. Offering plenty of activities, amenities and services, North Bay's vibrancy is only exceeded by its hospitality. In addition to the activities available to you on campus, North Bay offers so much more:

Getting around town is easy with your full-time student card which doubles as a city bus pass.

Campus sits on
720
acres of Canadian Shield
forest

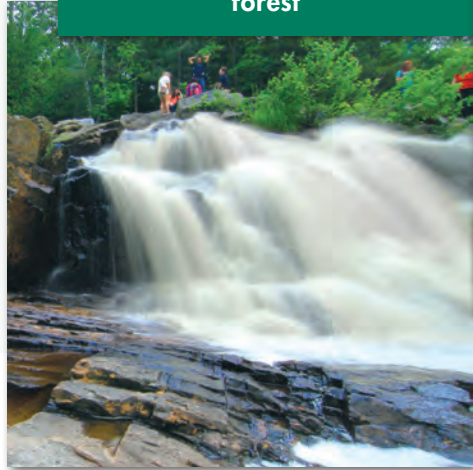

- YMCA with pool
- Arenas (Memorial Gardens hosts our local OHL team, the Battalion)
- Shopping malls, local businesses
- Restaurants and bars
- Downhill ski and snowboarding hills (one in the city, and a second within a 45 min drive)
- Nordic ski clubs
- Biking paths and walking trails
- Golf courses and tennis courts
- Public beaches ideal for swimming and canoeing
- Capitol Centre (features theatre performances and concerts)
- Art galleries
- North Bay Museum
- Community festivals and events
- Transportation via city bus, taxi or online ride service



“As a student from India studying human resources at Nipissing, I have found the staff and faculty to be very warm, welcoming and accommodating to my needs. Nipissing is a multicultural community and I'm proud to be a part of it.”

— Suni C., Business Student

Residence



Top-notch residences with private, single bedrooms

A private bedroom of your own

Our top-rated residences will make you feel right at home. You can count on making fast friends within your residence community, and enjoy the luxury of a private room of your own!

Our student leaders, Residence Dons and residence staff give tutorials on everything from the basics of laundry and cooking to making connections within the community. Our Community Assistants and Academic Dons are additional support for residents in each complex to help with a smooth transition into university.

For full details, visit nipissingu.ca/residence

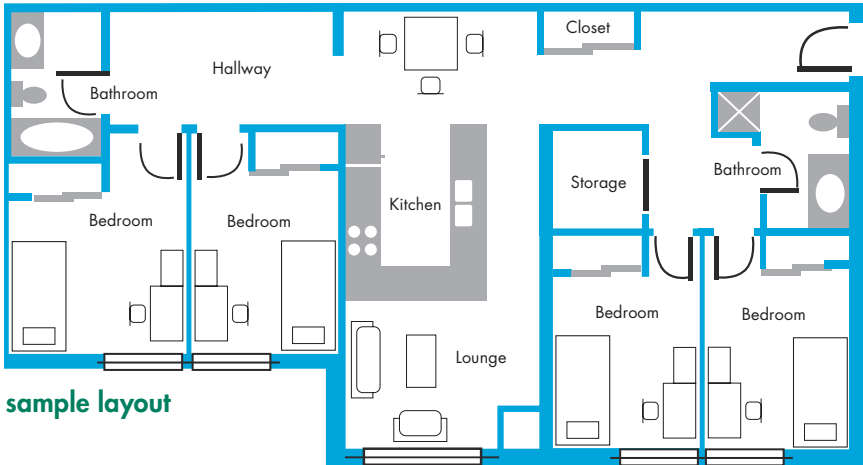

sample layout



When the weather gets cold enough, the residence skating rink is flooded for students to skate for fun or play a friendly game of hockey!

How to Apply

International Applicants Applying Full-time (studying in Canada on a study permit or studying in another country with no current status in Canada)		
Students attending an Ontario curriculum secondary school	Undergraduate Application	Apply by visiting ouac.on.ca
Students attending a Canadian curriculum secondary school (other than Ontario)	Nipissing International Application Portal	Apply by visiting nipissingu.ca/applyintl
All other international applicants		

Please visit nipissinglakers.com or email internationaladmiss@nipissingu.ca for more information.

International College or University Transfer Applicants

Applicants who have attended or are currently attending a recognized institution will be considered for admission based on their postsecondary studies. Program prerequisites must be met through previous secondary or previous/current postsecondary studies. Further information on prerequisite courses can be found in this brochure under Admission Requirements. Courses completed from a recognized institution may be eligible for transfer credit consideration. Transfer credits are assessed after applicants accept their offer of admission. Students possessing an undergraduate degree may be eligible for admission consideration to a second undergraduate degree program in another area of study.

Get more information on how to apply at: nipissinglakers.com

Nipissing University is surrounded by nature, with beautiful hiking trails and a waterfall right on campus.



English Language Proficiency Policy

Applicants to programs offered at Nipissing University whose first language is not English will be required to achieve the required proficiency level on one of the following tests of English language proficiency for admission consideration.

English Proficiency Test	Undergraduate Programs	Post Baccalaureate Programs	BScN	BEd & Graduate Programs
IELTS	6.5 – No bands less than 6		7 – No bands less than 6.5	6.5 – No bands less than 6.5
TOEFL IBT	83 with a minimum score of 20 in reading, listening and writing, and a minimum score of 22 in speaking		93 with a minimum score of 20 in reading and listening and a minimum score of 22 in writing and speaking	
PTE – Pearson Test of Academic English	58 with a minimum score of 56 in each section		63 with a minimum score of 60 in each section	
CAE – Cambridge Assessment English	C1 minimum overall score of 176 with a minimum score of 169			
CAEL/ CAEL Online – Canadian Academic English Language	60 with no band less than 60		70 with no band less than 60	

Safe, small, friendly community



Admission Requirements

The following are the minimum admission requirements for admission consideration to Nipissing University. Applicants are required to achieve a high overall standing in their studies and must include the appropriate program specific prerequisites depending on the degree program applied to. All applicants are considered on an individual basis. Meeting the minimum admission requirements does not guarantee admission.

	General Requirements
International Baccalaureate (IB)	Applicants who have completed the full International Baccalaureate (IB) diploma with at least six subjects, including three at the higher level, with a minimum grade total of 24 (not including bonus points) may be eligible for admission consideration. Transfer credit to a maximum of 30 credits may be granted for courses completed at the higher level or standard level with a grade of 5 or higher.
American School System/ Advanced Placement (AP)	Applicants who have graduated with a "B" average from Grade 12 at an accredited high school may be eligible for admission consideration. Applicants must present SAT or ACT scores regardless of citizenship. Prerequisite subjects completed at the Freshman or Sophomore level are not acceptable. Transfer credit will be granted to a maximum of 18 credits for AP courses completed with a grade of 4 or better. Nipissing's SAT code is 4149 and ACT code is 5167.
General Certificate of Education (GCE British Patterned Education)	Applicants who present a minimum of the General Certificate of Education (GCE) with satisfactory standing in at least five subjects, two of which must be at the advanced level, or satisfactory standing in at least four subjects, three of which must be at the advanced level may be eligible for admission consideration. Two Advanced Supplementary/Advanced Subsidiary (AS) subjects are considered equal to one Advanced Level subject for admissions purposes. Transfer credit may be awarded for A Level results. It is highly recommended that prerequisites be completed at the A Level.

#1 in Student Services - supporting your success



	General Requirements
International School Systems	Applicants possessing the requirements necessary for admission to a recognized university in their home country may be eligible for admission consideration. Prerequisite subjects must be met. All prerequisites should be completed at the senior secondary school level. Further information can be found at nipissingu.ca/internationaladmissions or by contacting internationaladmiss@nipissingu.ca

For full admission requirements please contact internationaladmiss@nipissingu.ca



The Government of Canada offers a pathway to permanent residency for skilled foreign workers who want to work and live in our community of North Bay, Ontario. Many of our students have been successful and are now permanent residents, living and working in North Bay and across Canada. Contact us today to learn more about the pathways available.



Our Grads Get Jobs

Over **96.8%** of Nipissing University students find employment within six months of graduating.

At Nipissing University, you'll find a welcoming, inclusive community ready to support your success—both academically and personally. With award-winning services and a campus designed to feel like home, your future starts here.



North Bay is about a 3.5 or 4 hour drive from Toronto and Ottawa



nipissinglakers.com

   @NipissingU
 @nipissing_university



International Office • 100 College Drive, Box 5002, North Bay, ON P1B 8L7
tel: (705) 474-3450 ext. 4433 • fax: (705) 495-1772
nipissinglakers.com • internationaladmiss@nipissingu.ca

If you would like to request this publication in an alternative format please contact the External Relations Office at (705) 474-3450 ext. 4078 or email marketing@nipissingu.ca